

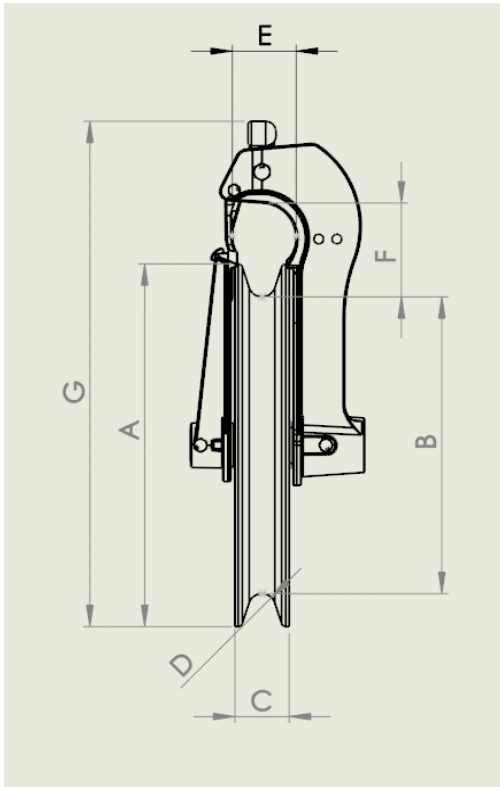

STR Series Block

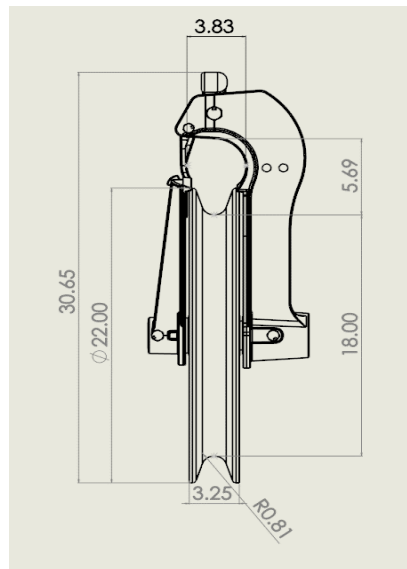

Part Number	General Dimension in Inches							Weight (lb)	Safe Working Load (lb)
	A	B	C	D	E	F	G		
STR-22	22.00	18.00	3.25	0.81	3.83	5.69	30.65	51	12,000
STR-28	28.00	24.00	3.54	1.00	4.17	5.78	37.81	70	12,000



22"

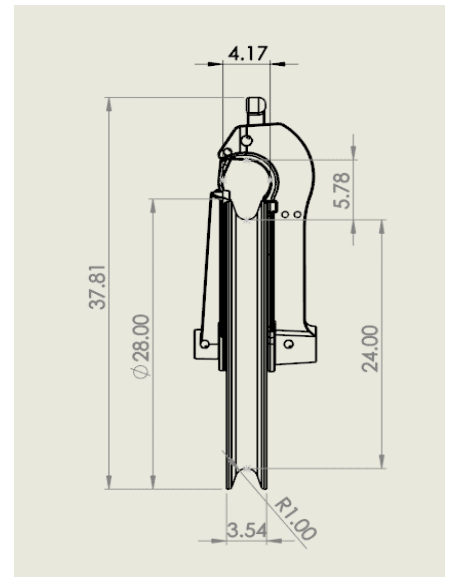

28"

General Tech. Data

T6 heat treated high-strength aluminum alloy A356 for entire frame construction.

Precision ground, deep-groove type shielded ball bearings.

All ferrous components are protected from corrosion by Zinc plated or hot dip galvanized.

Pulling line sheaves are lined with high strength, wear resistant uv protected urethane.

30K ball-eye socket clevis to match with all standard fittings.

Safe Working Load is referenced to Single Resultant Vertical Load on Center (Pulling Line) Sheave.

Available in sheave sizes from 16" to 35". Safe working loads range from 12,000 lbs to 15,000 lbs

Conductor ranges covered include 3/0 CIR. MIL. ACSR to 2515 CIR. MIL. ACSR.

The following types of optional attachments are available:

Helicopter arm

Ground attachment

Stringer strap (patent pending)

Design and specifications are subject to change without notice.

